



Stainless steel door „Teckentrup Water-2“

optionally with glazing

Text example:

Water-2 stainless steel door, double-skinned, filled with water-repellent insulating material. Double-leaf door element. Active door leaf DIN right. Door leaf V2A 1.4301, canvas structure. Door leaf 52 mm thick, thick rebated on 3 sides. Corner frame V2A 1.4301, 2 mm thick, with 3-sided seal. Mortice lock with latch lever in accordance with DIN 18250, prepared for profile cylinder with V2A lock plate. FS round handle set V2A. 1 security bolt V2A per leaf. 2 KO hinges in V2A with ball bearings. „Teckentrup“ or equivalent.

(Compile and tender according to requirements. Please refer to technical data below for respective details. Updated 1. April 2018)

Technical data

Product:	„Teckentrup Water-2“	
Installation in:	<ul style="list-style-type: none"> ▪ Masonry ▪ Concrete 	
Dimensions	Width:	1375 - 2500 mm
	Height:	1750 - 2500 mm
Type of handing	DIN right or DIN left	
Door leaf	Double-skinned, rebated on 3 sides, thick rebate Insulation: Water-repellent insulating material Sheet thickness: 0.8 mm Door leaf thickness: 52 mm Security bolt V2A per leaf: 1	
Frame	Stainless steel corner frame, 2 mm thick with 3-sided seal and bottom sill, 3 welded-on stainless steel wall anchor plugs on each side. Special equipment: Block frame and counter or closed frame, stainless steel	
Surface	Door leaf:	V2A 1.4301, 240 grain size
	Frame:	V2A 1.4301, 240 grain size
Fittings	<ul style="list-style-type: none"> ▪ 2 (4) KO hinges in V2A with ball bearings Active door leaf ▪ Mortice lock with latch lever in acc. with DIN 18250, prepared for profile cylinder with V2A lock plate ▪ FS round handle set, V2A 	
Glazing:	Wire or ISO glass with V2A glazing frame or rubber clamping profile Max. size 1000 x 1500 mm (window size)	
Special equipment	<ul style="list-style-type: none"> ▪ Handle sets / Lever/Knob sets: <ul style="list-style-type: none"> ▪ Plastic ▪ Light metal ▪ Stainless steel ▪ With short plate or rose escutcheon (various makes) ▪ With fixed outer knob ▪ Locks <ul style="list-style-type: none"> - Profile cylinder 35.5 + 40.5 mm - Panic locks ▪ Top door closer DIN EN 1154 ▪ Spring hinge ▪ Floor seals ▪ Rectangular glazing (special size) ▪ Round glazing max. Ø 600 mm with rubber clamping profile ▪ Aluminium ventilation grille ▪ Steel transformer grille ▪ Aluminium rain guard 	

	Ordering dmsions/ Modular dimesions width x height	Clear opening dimensions width x height
Standard sizes	1500 x 2000	1416 x 1961
	2125	2086
	1750 x 2000	1666 x 1836
	2125	1961
	2000 x 2000	1916 x 1961
	2125	2086
	2500	1961
	2125 x 2125	2041 x 2086
	2250 x 2250	2166 x 2208
	2500 x 2500	2416 x 2458

(Special sizes: from 1500 x 1750 up to 2500 x 2500)



Stainless steel door „Teckentrup Water-2“

optionally with glazing

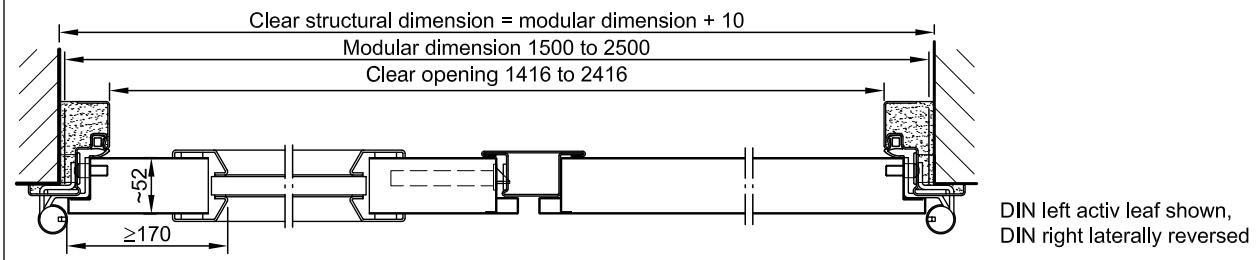
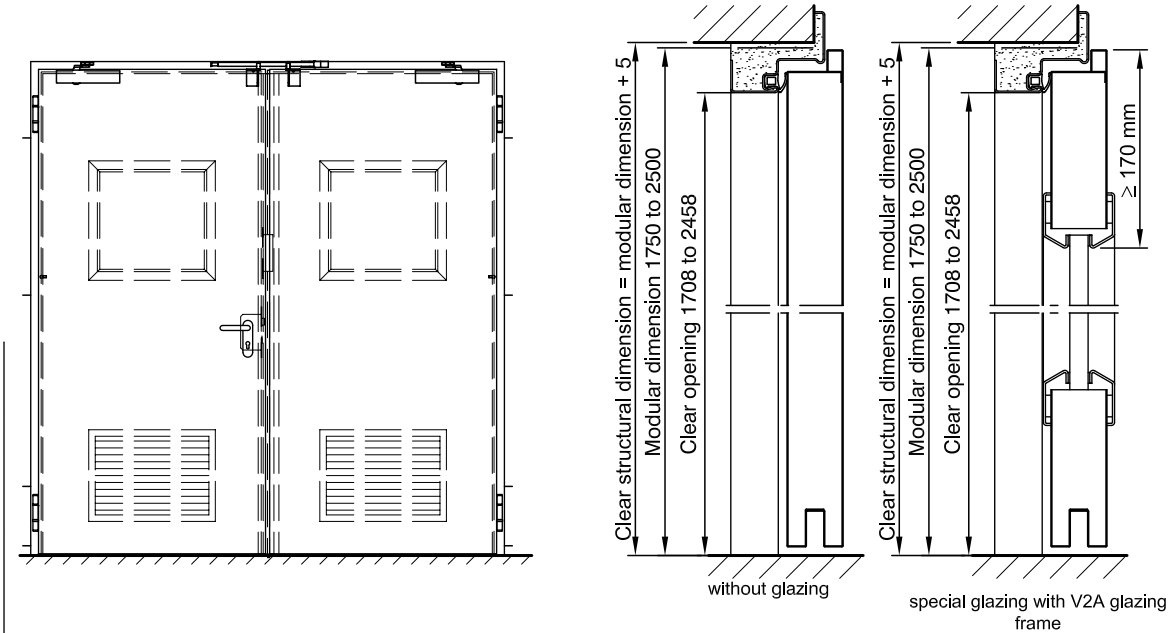

Floor connections:
 Image 1: With bottom buffer
 Image 2: With bottom buffer/seal
 Image 3: With bottom seal (smoke-proof door with top door closer)
 Image 4: sliding threshold seal

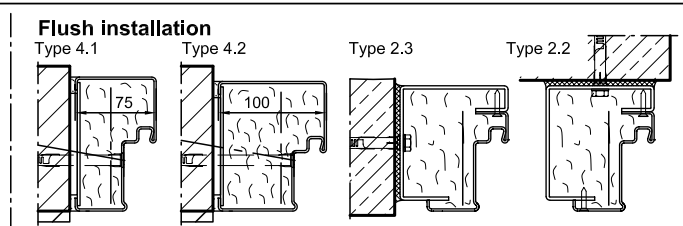
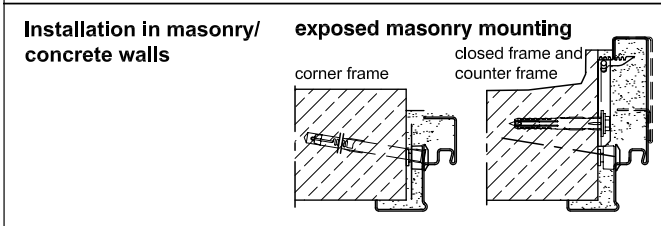
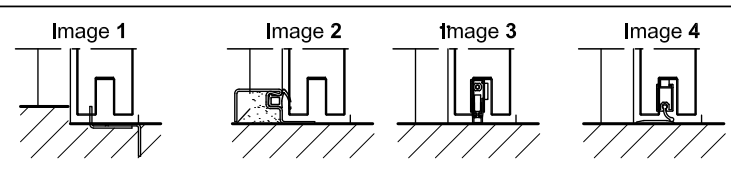

Please find a detailed installation overview in the planning-, installation- and maintenance manual for 1-leaf and 2-leaf doors.